

















iDataCable

HI-D71

User Manual
English

<u>Introduction</u>		Page 3
<u>Download App</u>		Page 4
<u>Internal and External Storage</u>		Page 5–6
<u>Import Pictures and Videos</u>		Page 7
<u>Share Files</u>		Page 8
<u>Store Files from Third-Party Apps</u>		Page 9
<u>Compress and Extract Files</u>		Page 10–11
<u>Icon Definitions</u>		Page 12
<u>Use and Manage the Pictures Category</u>		Page 13
<u>Use and Manage the Music and Movies Category</u>		Page 14
<u>Use and Manage the Documents Category</u>		Page 15
<u>Use and Manage the All Files Category</u>		Page 16
<u>Use the Camera Function</u>		Page 17
<u>Use the Contacts Function</u>		Page 18
<u>Check the External Storage Status</u>		Page 17
<u>Clear Cache</u>		Page 19
<u>Upgrade Firmware</u>		Page 19

Thank you for purchasing MiLi iDataCable!

Product Features

- Exquisite Design: Made from aluminum alloy to combine style with durability.
- LED Indicator Light: Hidden LED indicator light to show TF card reading/writing activities in stealth-like fashion.
- All Purpose Cable: The 3-in-1 cable charges while simultaneously acting as a flash drive for both your phone and PC.
- Added Flexibility: The TF card slot on the USB end allows you to choose different capacities of the TF card to fit your storage needs.
- Enhanced Mobility: Small and Compact, with an integrated fastening tape for easy storage.

Listed below are a few of the many exceptional features of iDataCable:

- Once you connect iDataCable with your iPhone, iData Pro App allows you to manage your photos, videos, music and documents stored in the TF card placed on the USB end of iDataCable with ease.
- The free iData Pro App automatically organizes all files by type. Find all of your Pictures, Music, Movies, and Documents where they belong.
- The iData Pro App has a built-in audio and video players and photo viewer making it easy to enjoy all your media files directly on the TF card placed on the USB end of iDataCable.
- With the iData Pro App, you can share the files on your TF card via third-party apps such as QQ, Whatsapp, Facebook, Twitter, WeChat, email, and more!

Compatible With

- iPad Touch/iPhone 5/5c/5s/6/6 Plus/6s/6s Plus
- iPad 4/iPad Air/iPad Air 2
- iPad Mini/iPad Mini 2/iPad Mini 3
- iOS 8.0 and above
- Windows/Mac OS, using USB

Download App

You will need a TransFlash (TF) card and the iData Pro App in order to use the smart storage and management function of this device. Please scan the QR code below, or search for iData Pro in the App Store to download it directly.



iData Pro



Internal and External Storage

Insert a TF card to iDataCable card slot and then connect iDataCable to your iDevice, tap to enter the iData Pro App, and you will see two categories: Internal Storage and External Storage.



Internal Storage:

In iData Pro App, the Internal Storage is an independent storage space partitioned from the iDevice' s storage, but note it does occupy some actual storage space on the iDevice. Simply put, Internal Storage is an empty folder created on the iDevice, so it does not contain any files. However, since it shares the iDevice storage, you can still access it when your iDevice is not connected to the iDataCable.

Internal Storage is organized into five separate categories: Pictures, Music, Movies, Documents, and All Files.

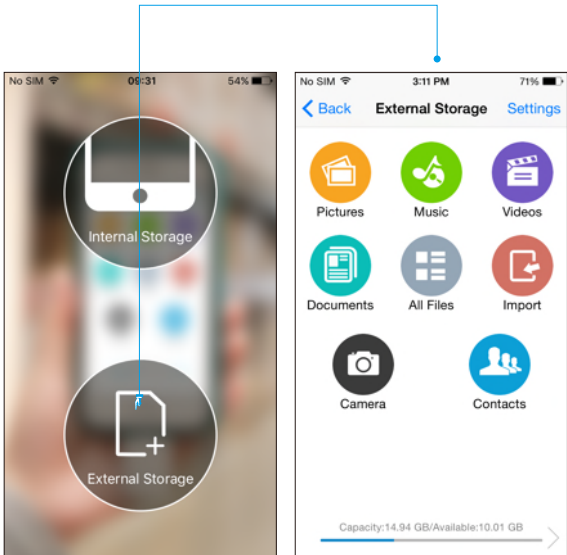

External Storage:

External Storage refers to the storage space on the TF card itself, which can be accessed only when your iDataCable is connected to your iDevice with an TF card inserted. You can import Pictures and Videos from your iDevice into your external TF card; as well as store Movies, Documents, Images and other Files from your computer to your external TF card.

Import Pictures and Videos

Tap the “Import” button and it will open the photo gallery on your iDevice. Select the Photo(s) or Video(s) you wish transfer and click “Import” . Next, choose the location where you would like your files to be saved and then click “Import Here” in the top right corner to start.



Share Files

Open or select the file/image you want to share and click the “Share” button. Locate the “Open in” button on the pop-up window and click on it. A list of third-party apps installed on your iDevice will appear on the window. Select the App that you would like to use to share your Files. Follow the images below for detailed instruction on how to share an image.

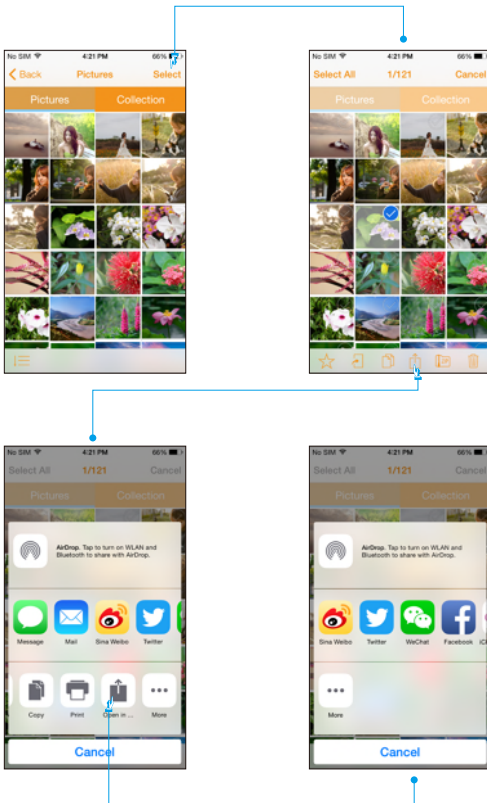

Store Files from Third-party Apps

Storing files from third-party Apps is easy to do. For example, to save an email attachment:

Download and open the attachment, click the “Share” button and select “Open in other Apps” on the pop-up window. Next, a list of Apps that support this function on your iDevice will appear on the window. After clicking “Open with the third party App”, a reminder message will appear stating, “Attachment from a third-party App has been saved to: Internal Storage/All Files”. Now, you can view and edit the File.



Compress and Extract Files

To Compress a File:

Select the File to be compressed then click the “Compress” icon. A dialog box will pop up asking for a File name for the new compressed file. Click “OK” to start the process.

The amount of time it takes is proportional to the size of the compressed file. Once completed, a “Reminder” box will pop up showing “The compressed file has been saved to the Zip folder”. You can view the compressed file in the “Zip” folder under “All Files”.

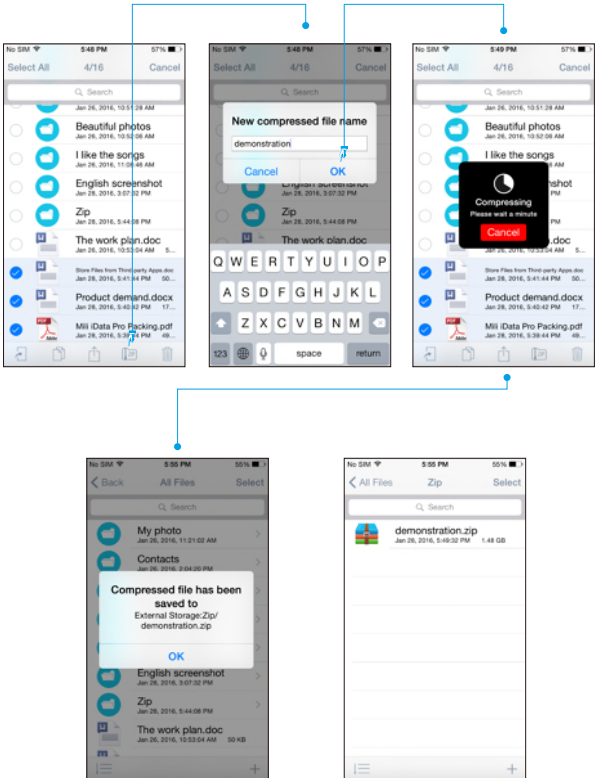

To extract a File:

Click on the file to be extracted, and click “OK” to confirm on the pop-up window. It will start to extract the file. The amount of time it takes is proportional to the size of the compressed file. Once completed, all files in the compressed file will be shown in the folder where the compressed file is located.

Note: Only Zip format is supported at this time. RAR format is not supported.

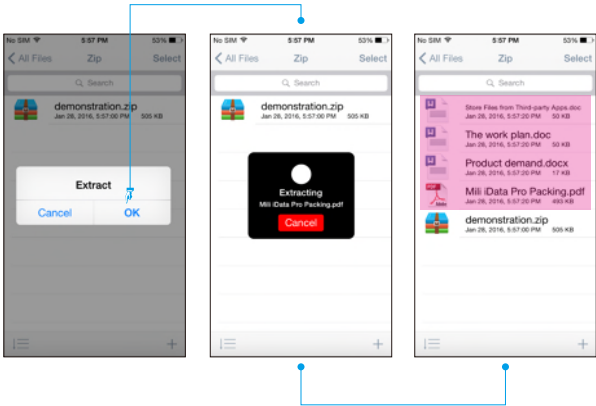

Icon Definitions



File order



Create a new folder/document



Add to Collection



Share



Move



Compress



Copy



Delete

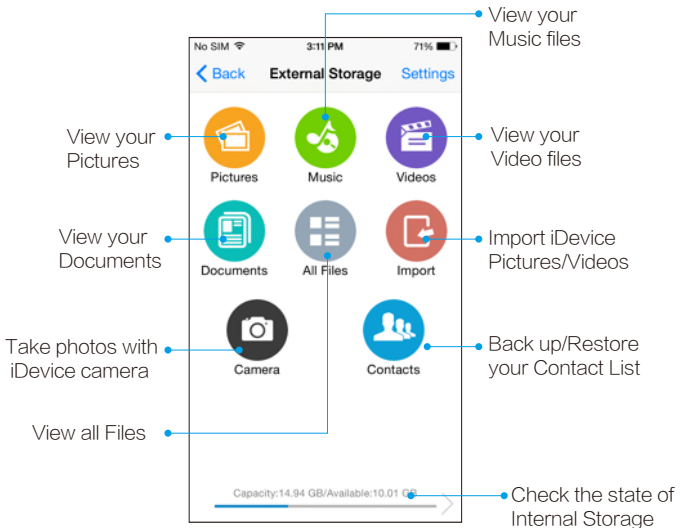

Use and Manage the Pictures Category

Click on the “Pictures” icon and you can view all the image files stored on the TF card placed on the USB end of iDataCable. On the “Pictures” page, click “Select” on the top right to select the photo that you need to move, copy, share, compress, delete or add to “Collection” .

Click “Collection” to view the photos that have been added to this folder. Click the “File order” button on the bottom left to view all or change the display order of the Pictures by day, month, or year.

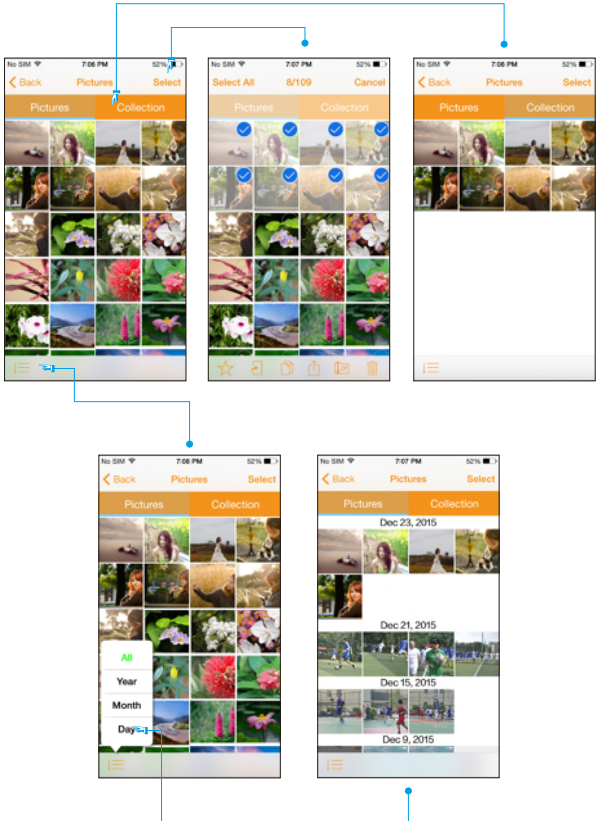

Use and Manage the Music and Movies Category

Select the “Music” category to view all music files stored on the TF card placed on the USB end of iDataCable. To move, copy, share, compress, delete or add collection files press “Select” and choose the action you want to perform.

Select “Collection” to view the files that have been added to this folder. Select the “File Order” icon to change the display order of your files by file type, file size, file name and date created. Slide the file to left to delete or rename the music file.

While playing music, you can re-arrange the “Play order” or view the “Playlist” . The same goes for video files.

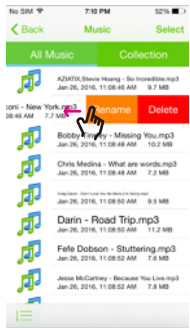
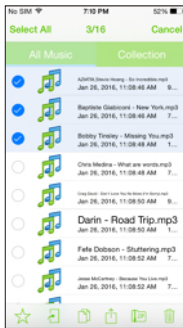
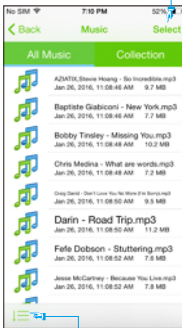

Play music

View video files

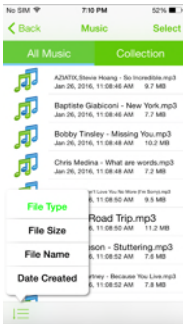

Use and Manage the Documents Category

Select the “Documents” icons to view all documents stored on the TF card placed on the USB end of iDataCable. The iData Pro App supports most document formats such as, Word, Excel, PPT, PDF, TXT, Pages, Number, Key, etc. To view the different formats of documents, select the document formats listed at the top. To copy, share, move, compress, delete or add collection files press “Select” and choose the action you want to perform. Select the “File Order” icon to change the display order of your files. Select “Collection” to view the files that have been added to this folder. Select the “File Order” icon to change the display order of your files by file type, file size, file name and date created. Slide the file to left to delete or rename the document.

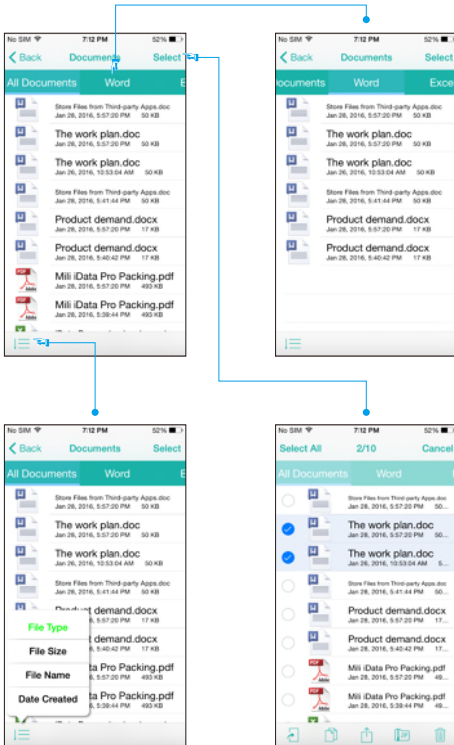

Use and Manage the All Files Category

Select the “All Files” icons to view all files stored on the TF card placed on the USB end of iDataCable. To view the different formats of documents, select the document formats listed at the top. To copy, share, move, compress, or delete a file press “Select” and choose the action you want to perform. Select the “File Order” icon to change the display order of your files. Select “Collection” to view the files that have been added to this folder. Select the “File Order” icon to change the display order of your files by file type, file size, file name and date created. Slide the file to left to delete or rename the music file. Select the “Create” icon to create a new folder or document.

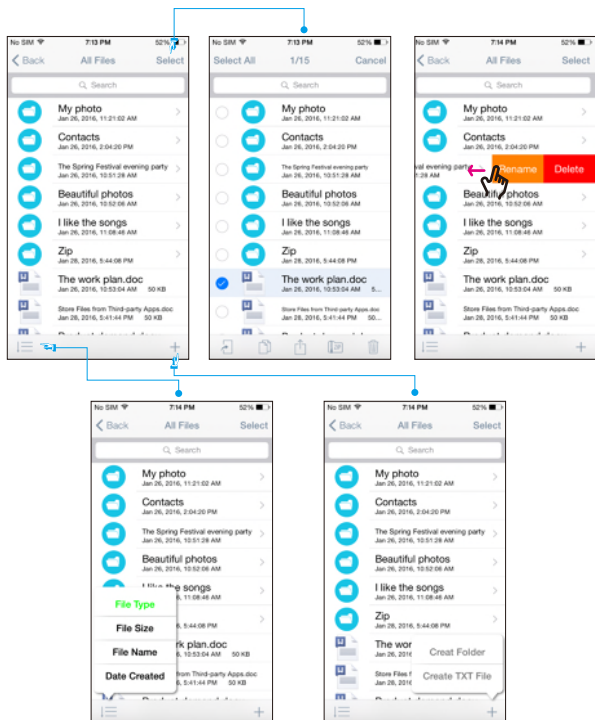

Use the Camera Function

Select the “Camera” button to take photos and record videos. These photos and videos will be stored directly on to the TF card placed on the USB end of iDataCable under the “All Files/ Camera” folder in External Storage. Any photos and videos taken with the iData Pro App will not take up storage space on your iDevice.

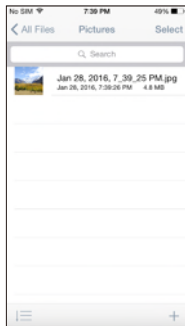
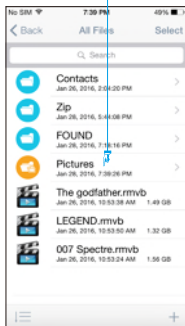

Check the External Storage Status

Select the “Storage Status Bar” on the bottom of the External Storage page and you can view details on the storage space available on the TF card placed on the USB end of iDataCable. In addition, you can find details on how the External Storage is used. You can view the amount of storage used by photos, videos, documents, and music files.

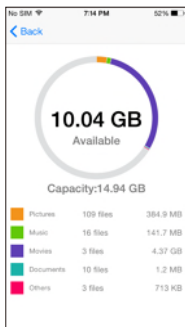
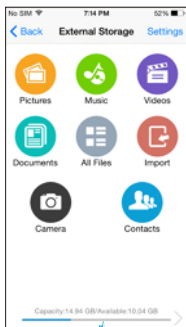

Use the Contacts Function

Select the “Contacts” button to view your contacts. Select “Back up to the TF card placed on the USB end of iDataCable” and a dialog box will appear asking, “Do you want to back up your contacts?”, then press “OK”. If you lose your contacts, insert your external TF card into iDataCable, connect iDataCable with your iDevice and select “Restore” and a dialog box will appear asking, “Do you want to restore this backup up to the contact list?”. Select “OK” to start the restore process. You can delete a backup file by clicking “Select” or by sliding the file to the left.

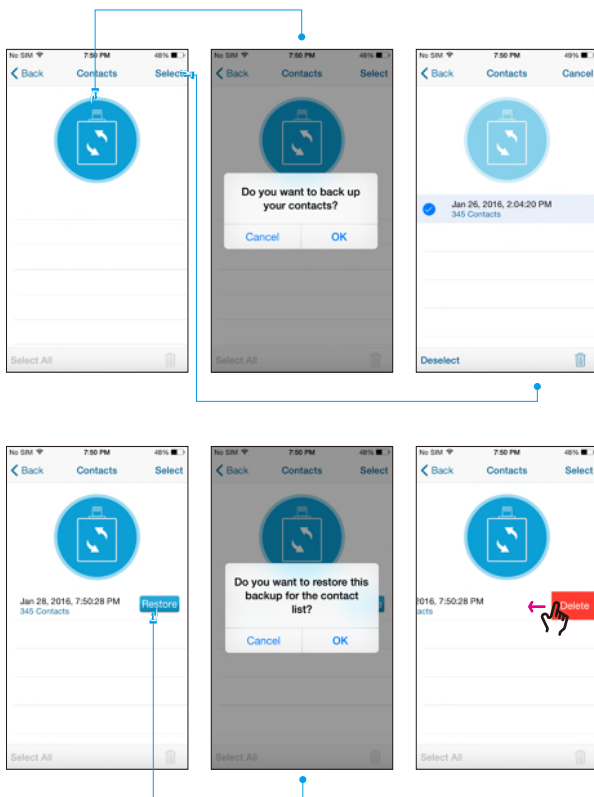

Clear Cache

The iData Pro App will create cache files. In order to keep the iData Pro App running smoothly we recommend clearing the cache regularly. On the Settings page, select “Clear Cache” and it will clear.

Note: After clearing the cache, photo thumbnails will be reloaded.

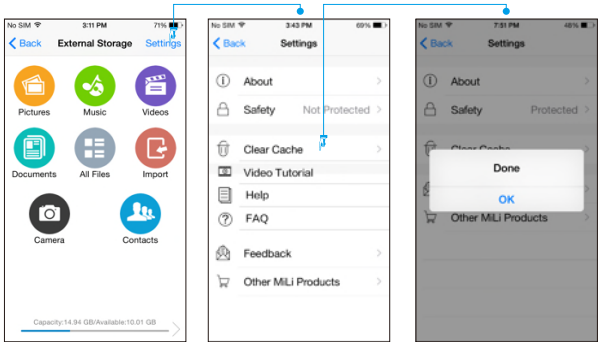

Upgrade Firmware

In order for the iData Pro App to run smoothly, the firmware may be updated to accommodate any iOS updates. To view the current firmware, select “Settings” and view the “About” page, you will see the firmware version. To upgrade, follow the same steps to view the firmware version, if there is an upgrade available it will be marked with a red message. Click on the red message to upgrade to the new version.

Note: The iDataCable App must be connected to the iDevice during the upgrade process. Any interruptions will require you to restart the process.

